



BEXHILL-ON-SEA TOWN COUNCIL

Sidley House, Allotments Boundary Report

April 2024

1. Introduction

The main objective of this report is to present from the Bexhill on Sea Town Council with important details regarding the allotment boundary updates. It aims to assist the council in making well-informed choices related to the distribution and supervision of allotment plots. The report focuses on the current state of fences, gates hedges, trees, and littering, within the allotment boundary, offering a comprehensive overview.

2. Fences:

As per the February Boundary Report, the recommended actions included replacing all four side fences and gates within the allotment Boundary, allotment fencing quotes were obtained from approved Tender Lux Commercial LTD, known as D&H Fencing and Landscaping.

The total amount for Preston Road & Sidley House Allotments is **£44,126.86 including VAT**

Breakdown of cost for Sidley House:

Total: **£11,062.53 includes VAT**

- They will bring in their excavator and clear away the spoil heaps and foliage away from the site. (They will need a permit for the use of the grass verge for access.)
- Installing new 1.8 green chain link fencing, around the perimeter of the area, along with 1 x lockable chain link gate.
- All 40mm x 40mm angle iron posts will be 3m apart and concreted into the ground.

Sidley House Gate





BEXHILL-ON-SEA TOWN COUNCIL

Sidley House, Allotments Boundary Report

April 2024

By addressing the current fencing issue will address the pressing security, weather-related, and wildlife damage concerns.

3. Hedges

- Under the maintenance budget for this year the hedges will be trimmed
- The External hedge trim of the conifers on All Saints Lane is on Rother's land they have said they do not have the budget to carry out the maintenance due to budget constraints.
- We have asked The Pelham for a quote which was £550. This is does not include any reduction in height and this includes the removal of trimmings and transfer to the green waste plot at Preston Road allotments.)



3. Maintenance

Maintenance for the year for both Preston Road and Sidley House allotment sites by The Pelham Building Enterprises Limited

Total cost: £2600

- Two Hedge cuts at Sidley House.
 - The image below details the hedge cutting at Sidley House, which will be done in May and August. The pink indicates the internal hedge and the orange indicates the external hedge
- All green waste from both allotments will be stacked and stored in the green waste section Plot 3B) on the lower Preston Road allotments.



BEXHILL-ON-SEA TOWN COUNCIL

Sidley House, Allotments Boundary Report

April 2024

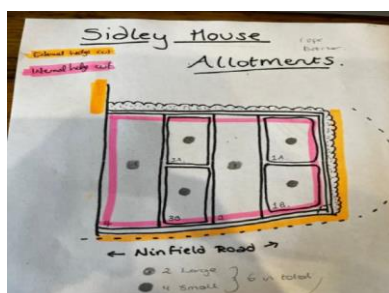

4. Trees:

Arboriculturist Inspection was carried out on both allotment sites, they are waiting to be paid before releasing the following:

- Preparation of a Plan showing the tree locations
- Tree Survey with the tree data
- Recommended management works

5. Litter

- Waste control contractor has removed all rubbish from the site
Before





BEXHILL-ON-SEA TOWN COUNCIL

Sidley House, Allotments Boundary Report

April 2024

After



7. Conclusion:

In summary, the boundary of the allotment area at Sidley House requires extensive repairs and improvements. With agreeing on the budgets for this year, work can be started by prioritising the repair of fences and gates, and addressing any other problems, the council can create a safer and more enjoyable environment for the plot holders.